



SIMPLY DELIGHTFUL



# Radisson Hotel Antwerp Berchem

Radisson enables guests to feel at ease throughout each stay – with relaxing spaces, thoughtfully considered details and unexpected delights. From our *Yes I Can!* service philosophy to consistently delivering on the essentials to offerings that help guests experience the local area, we're committed to delivering memorable moments for every guest.

## HOTEL FEATURES & AMENITIES

- 142 guestrooms
- full-service restaurant and bar
- call-and-collect option
- 283 sq. feet of meeting & event facilities
- indoor fitness center
- breakfast options including a breakfast buffet or grab-and-go
- free Wi-Fi in all guest rooms and social spaces
- delightful sleep experience with plush bedding and pillows
- same-day laundry service during weekdays
- underground parking

## AREA ATTRACTIONS

- walk through the Zurenborg area with the Cogels-Osylei street as highlight
- grab a drink or dinner at Dageraadplaats, the hotspot by locals
- pass by 't Groen Kwartier for a cosy evening
- visit Antwerp's own brewery De Koninck and get a taste of a real "Bolleke" or "Triple d'Anvers"
- take a relaxing stroll to the Brialmont Park, 5 minutes from the hotel
- a 3-minute trainride to Central Station and the Zoo

Radisson Hotel Antwerp Berchem  
Borsbeeksebrug 34, 2600 Berchem (Antwerp), Belgium  
+32 3 432 77 00  
[radissonhotels.com/radisson](https://radissonhotels.com/radisson)

# Floor plan

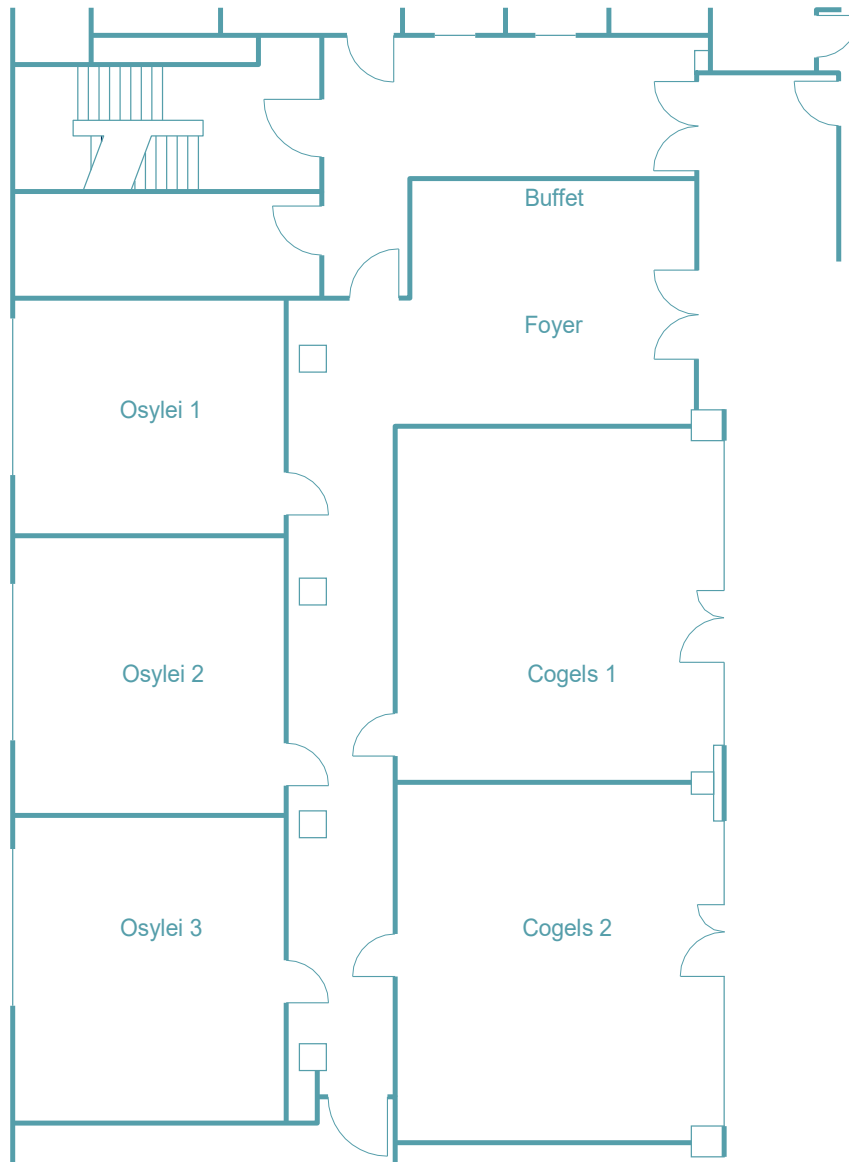

Rooms	Boardroom	Theatre	Classroom	U-shape	Cabaret	Reception	Dinner	Ceiling height	Length & width	m <sup>2</sup>
<b>Cogels 1</b>	<b>16</b>	<b>60</b>	<b>30</b>	<b>18</b>	<b>24</b>	<b>40</b>	<b>30</b>	<b>2.7</b>	<b>7.5 x 6.9</b>	<b>55</b>
<b>Cogels 2</b>	<b>16</b>	<b>50</b>	<b>24</b>	<b>18</b>	<b>24</b>	<b>40</b>	<b>30</b>	<b>2.7</b>	<b>7.5 x 6.9</b>	<b>55</b>
<b>Cogels 1 + 2</b>	<b>36</b>	<b>124</b>	<b>60</b>	<b>42</b>	<b>60</b>	<b>90</b>	<b>75</b>	<b>2.7</b>	<b>15.3 x 6.9</b>	<b>110</b>
<b>Osylei 1</b>	<b>10</b>	<b>24</b>	<b>12</b>	<b>12</b>	<b>12</b>	<b>20</b>	<b>15</b>	<b>2.7</b>	<b>5.1 x 5.7</b>	<b>30</b>
<b>Osylei 2</b>	<b>14</b>	<b>36</b>	<b>18</b>	<b>16</b>	<b>12</b>	<b>20</b>	<b>15</b>	<b>2.7</b>	<b>5.9 x 5.7</b>	<b>36</b>
<b>Osylei 3</b>	<b>14</b>	<b>36</b>	<b>18</b>	<b>16</b>	<b>12</b>	<b>20</b>	<b>15</b>	<b>2.7</b>	<b>6.5 x 5.7</b>	<b>39</b>
<b>Osylei 1 + 2</b>	<b>28</b>	<b>56</b>	<b>36</b>	<b>30</b>	<b>24</b>	<b>50</b>	<b>45</b>	<b>2.7</b>	<b>11 x 5.7</b>	<b>66</b>
<b>Osylei 2 + 3</b>	<b>32</b>	<b>65</b>	<b>42</b>	<b>32</b>	<b>24</b>	<b>50</b>	<b>60</b>	<b>2.7</b>	<b>12.4 x 5.7</b>	<b>75</b>
<b>Osylei 1 + 2 + 3</b>	<b>44</b>	<b>100</b>	<b>60</b>	<b>44</b>	<b>48</b>	<b>80</b>	<b>75</b>	<b>2.7</b>	<b>17.5 x 5.7</b>	<b>105</b>
<b>Cogels + Osylei</b>	<b>-</b>	<b>220</b>	<b>140</b>	<b>60</b>	<b>150</b>	<b>250</b>	<b>180</b>	<b>2.7</b>	<b>17.5 x 14.8</b>	<b>283</b>